



METAL CABLE GLANDS EMC TYPE BRASS

TECHNICAL DETAILS

Material

| | |
|-------------------|---|
| Cap nut | : Brass with nickel plated |
| Clamping insert | : Polyamide PA6 V2 |
| Sealing ring | : TPV |
| Emc spring | : AISI301 |
| Gland body | : Brass with nickel plated |
| O-ring | : NBR |
| Connection thread | : Metric (EN60423)/PG (DIN 40430) |
| Certificates | : ROHS, CE |
| Protection class | : IP68 - 5 bar |
| Temperature range | : -20 °C +100 °C -40 °C +150 °C (short term) |

Properties

Easy to assemble
For cables with shielding
Suitable for cables with and without inner sheath
Highly conductive

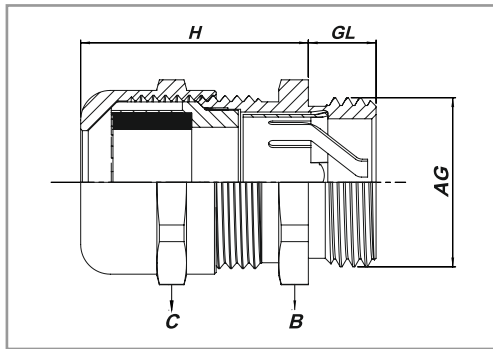

METRIC/PG THREAD CABLE GLANDS

| AG Thread | Code | H mm | GL mm | B mm | C mm | mm |
|--------------|-----------|---------|----------|---------|---------|---------|
| M 12 x 1,5 | OMBT 01 | 26 | 6 | 17 | 17 | 3 - 6,5 |
| M 16 x 1,5 | OMBT 02 | 23 | 7 | 18 | 17 | 4 - 8 |
| M 20 x 1,5 | OMBT 03 | 26,5 | 8 | 22 | 22 | 6 - 12 |
| M 25 x 1,5 | OMBT 04 | 28 | 8 | 27 | 24 | 10 - 14 |
| M 32 x 1,5 | OMBT 05 | 31,5 | 9 | 34 | 30 | 13 - 18 |
| M 40 x 1,5 | OMBT 06 | 38 | 9 | 43 | 40 | 18 - 25 |
| M 50 x 1,5 | OMBT 07 | 43 | 9 | 55 | 50 | 22 - 32 |
| M 63 x 1,5 | OMBT 08 | 48 | 14 | 68 | 64 | 33 - 44 |
| M 75 x 1,5 | OMBT 18 | 58 | 20 | 90 | 90 | 50 - 63 |
| M 80 x 2,0 | OMBT 1880 | 58 | 20 | 90 | 90 | 50 - 63 |
| M 90 x 2,0 | OMBT 19 | 61 | 20 | 100 | 100 | 60 - 70 |
| PG 7 | OPBT 01 | 26 | 6 | 17 | | 3 - 6,5 |
| PG 9 | OPBT 02 | 23 | 6 | 17 | | 4 - 8 |
| PG 11 | OPBT 03 | 24,5 | 6 | 20 | | 5 - 10 |
| PG 13,5 | OPBT 04 | 26,5 | 6,5 | 22 | | 6 - 12 |
| PG 16 | OPBT 05 | 28 | 6,5 | 24 | | 10 - 14 |
| PG 21 | OPBT 06 | 31,5 | 7 | 30 | | 13 - 18 |
| PG29 | OPBT 07 | 38 | 8 | 40 | | 18 - 25 |
| PG36 | OPBT 08 | 43 | 10 | 50 | | 22 - 32 |
| PG42 | OPBT 09 | 47 | 12 | 57 | | 30 - 38 |
| PG48 | OPBT 10 | 48 | 14 | 64 | | 33 - 44 |

* Long thread versions are also available.